

Amendment	Description

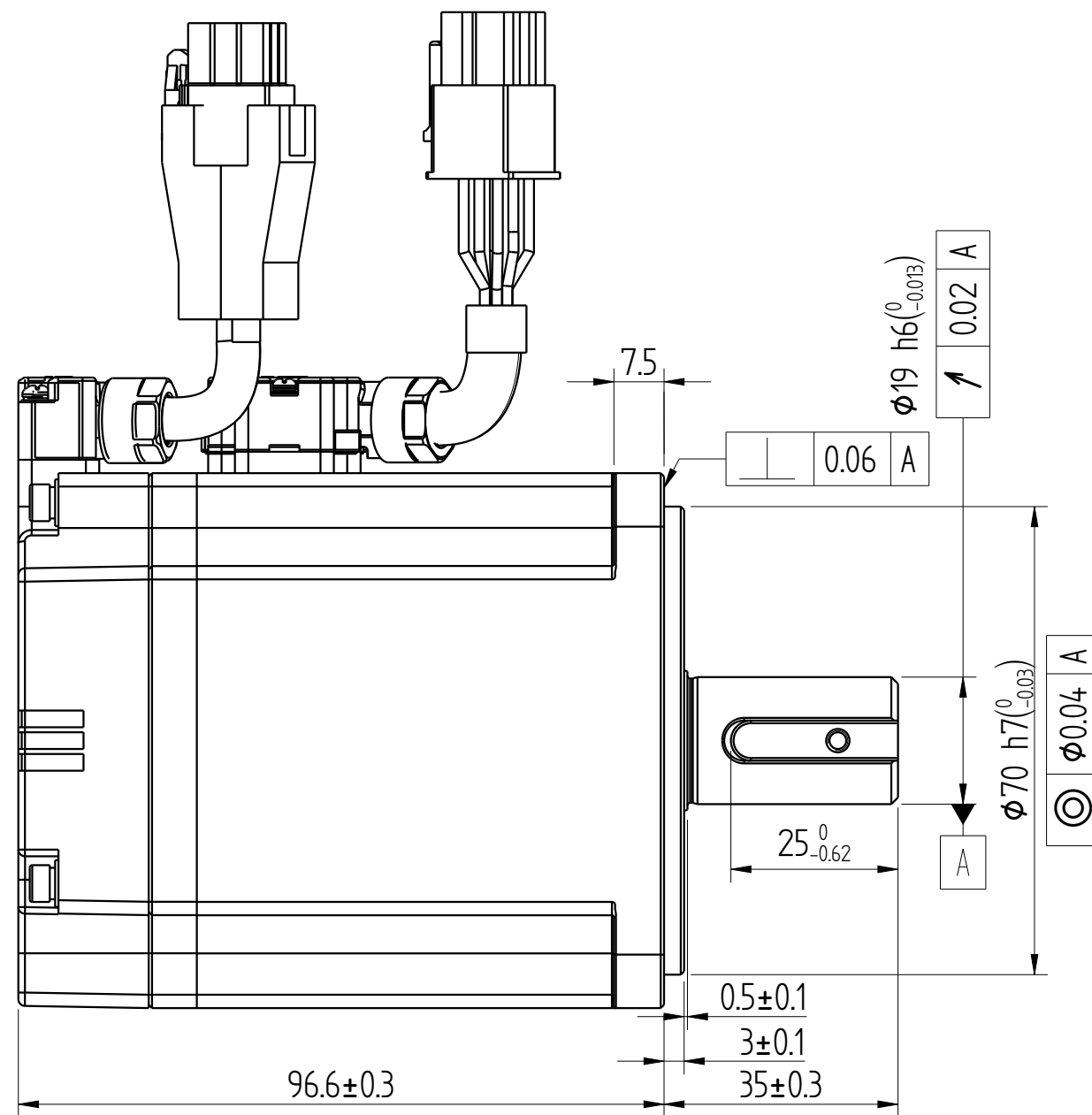

Basic function parameters	
Rated power kW	0.55
Rated voltage V	220
Rated current A	3.9
Peak current at rated speed A	15
Rated torque Nm	1.75
Peak torque at rated speed Nm	6.13
Rated speed rpm	3000
Max speed rpm	7000
Rotor inertia kg·cm ²	0.55±10%
Encoder resolution	23bit
Insulation class	F(155)
Protection class	IP67
Static torque of brake Nm	/
Brake power supply V	/
Brake backlash°	/
Duty cycle	S1
Radial load N	≤392
Axial load N	≤147

Encoder adapter connector Power wire adapter connector

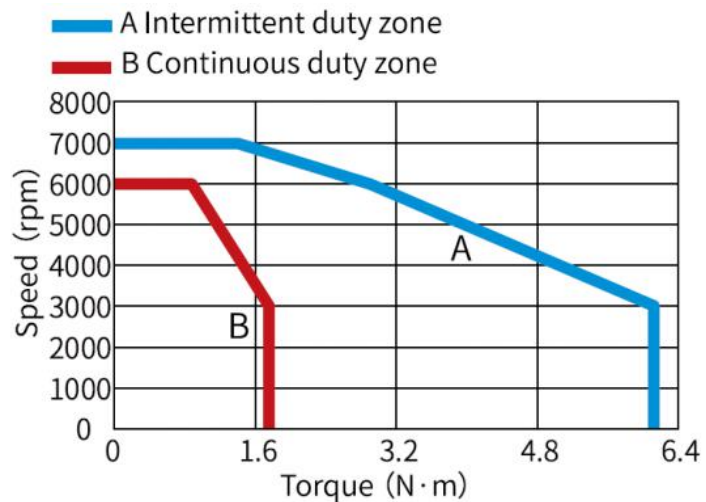
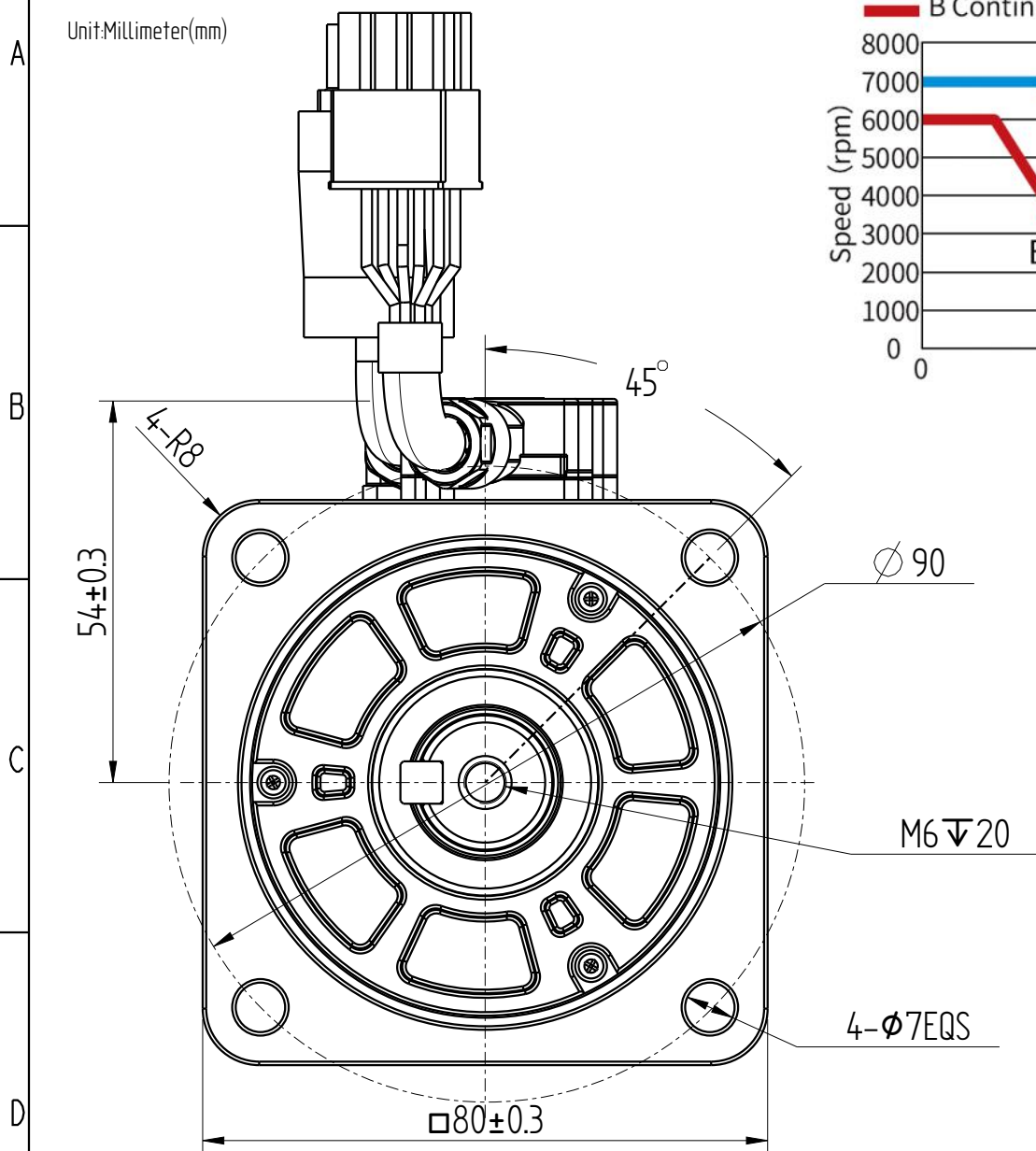
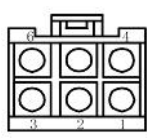
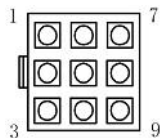

Encoder adapter connector

9pin terminal	3	6	1	4	9	8	7
Core color	blue	purple	brown	black	red	orange	ground wire
definition	PS+	PS—	DC+	DC—	+5V	0V	shield
	Pair		Pair		Pair		

Power wire adapter connector

6pin terminal	5	4	2	1	3	6
Core color	chartreuse	red	yellow	white	brown	blue
definition	PE	W	V	U	BK+	BK—

note:
1、The lead wire cable length about 300mm

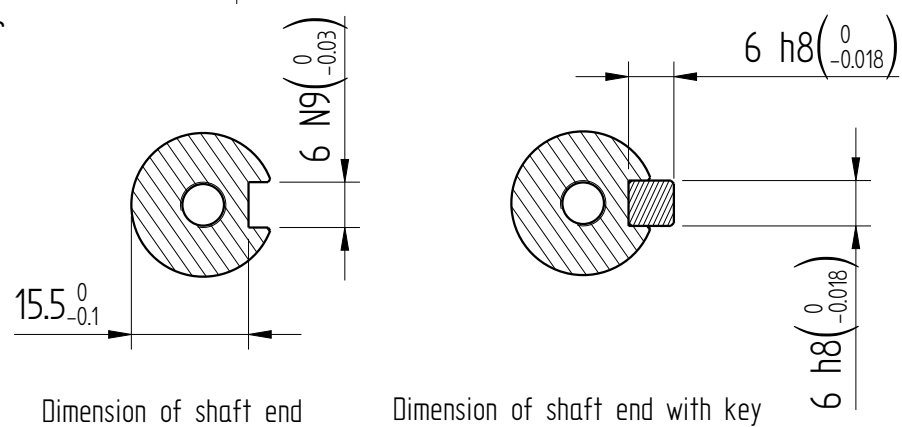

Dimension of shaft end

Dimension of shaft end with key

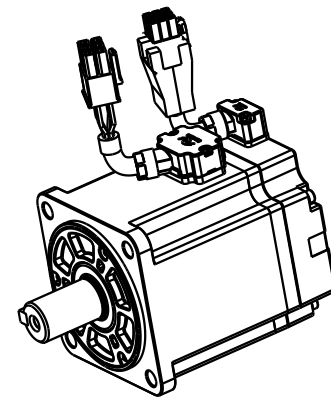

				Motor Outline Drawing			0111A164-WX	
B01	Replace	/	0.5520250527					
Version	Change method	Changed by	Date					
Design	/			/			Mark	
Check	/							
Craft	/							
Verify	/							
Standardization	/			Weight	Scale	Version	Page 1 of 1	
Approve	/			1.88kg	12	B01	Model	MS1H1-55B30CB-A331R-S-INT